

THE INFORMATION CONTAINED IN THIS DRAWING IS THE SOLE PROPERTY OF THE SSC CONTROLS COMPANY AND IS NOT TO BE USED, REPRODUCED, OR DISCLOSED WITHOUT THE EXPRESS WRITTEN PERMISSION OF THE SSC CONTROLS COMPANY.

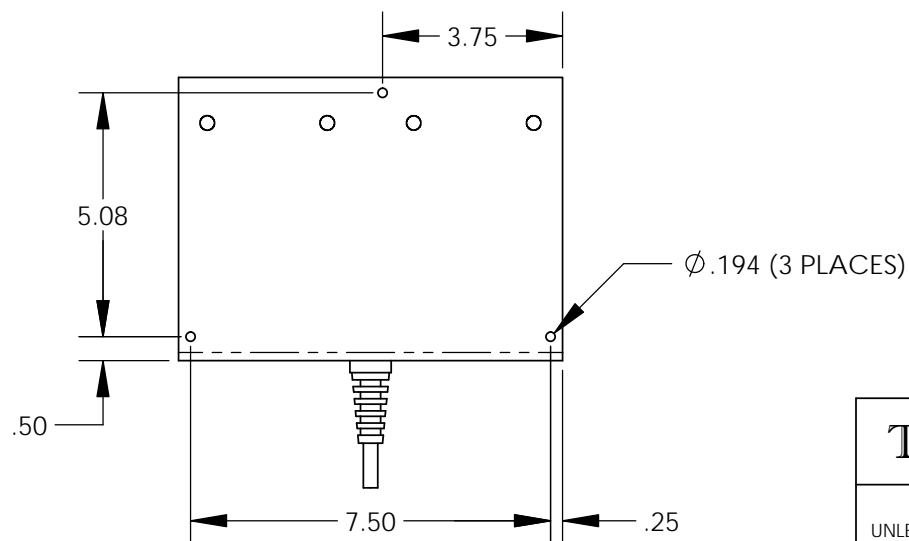

NOTE: BUMPER FEET REMOVED IN THIS VIEW TO SHOW MOUNTING HOLES.

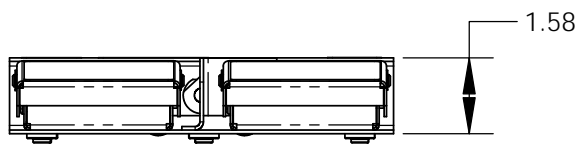
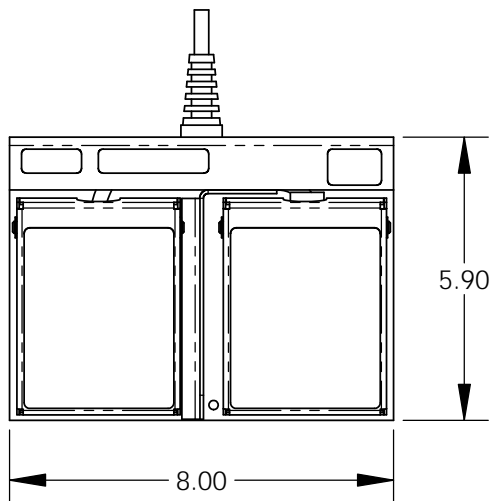
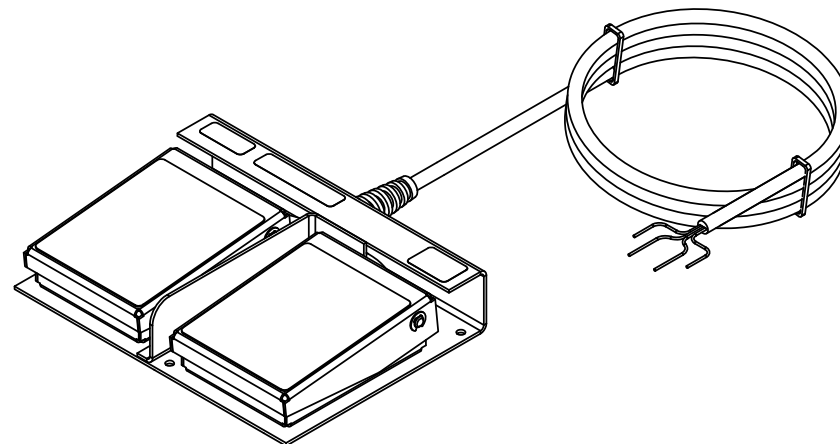

ELECTRICAL RATING:
13 AMPS @ 125/250 VAC

ENCLOSURE RATING:
NEMA/UL/CSA ENCLOSURE TYPE 1
IEC 60529 IP 21

WEIGHT: 4.2 LB (1.9 KG)

NOTES:
ALL DIMENSIONS ARE FOR REFERENCE ONLY.
COMES STANDARD WITH BUMPER FEET.

The SSC Controls Company

8909 EAST AVENUE
MENTOR, OHIO, USA 44060

UNLESS OTHERWISE SPECIFIED,
DIMENSIONS ARE IN INCHES
AND TOLERANCES ARE AS FOLLOWS:

FOR 2 DECIMAL PLACES: $\pm .02$
FOR 3 DECIMAL PLACES: $\pm .002$
FOR ANGLES: $\pm .5$ OF A DEGREE

DRAWING INFORMATION

DRAWN BY: **BAM**

CHECKED BY: **JEM**

DATE: **7/28/06**

SCALE: **1:4**

DRAWING NAME:

**DIMENSION DRAWING
DS100**

DRAWING NUMBER:

20266-DIM